

# POWER MOLLER® 24

## SERIES PM486/500/570/605FE Brushless DC Motorised Roller INSTRUCTIONS

※ Motor driver card is NOT enclosed. It is separately supplied.

We thank you for your purchase of our Power Moller.

Please read this handling instructions first to understand the product, safety information and cautions before using the product. Keep the handling instructions at certain place, to be ready whenever needed. Make sure whether the product you received matches your purchase order, with its designation, specifications and operating voltage.

### To use the product properly and safely

- Do not use the product in explosive, ignitable gas, corrosive, watery (except waterproof, drip-proof unit) environment or around flammable products.
- Switch off the power, when conveyor removal, wiring or maintenance is done, otherwise you have a risk of electrical shock or injury.
- Respect the electrical regulations of the site or the equipment, where the product is installed. (Labour safety and sanitary regulations, electrical equipment technical standard, etc)
- Make sure the conveyor is grounded.
- Also make sure the Power Moller's shafts are tightly fixed using the standard mounting brackets supplied together, before operating the unit.
- Do not injure, pull, twist, nip nor additionally process the power cable.

### Power Source

- 24VDC Battery, or 24VDC Power Supply
- Battery or fullwave rectified and smoothed current <10% Ripple

### Standard (Hex shaft)

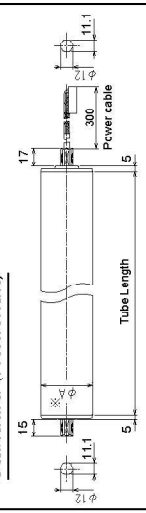

Roller diameter	PM486FE	PM500FE	PM570FE	PM605FE
Diameter φ (mm)	φ48.6	φ50.0	φ57.0	φ60.5

### Mounting bracket

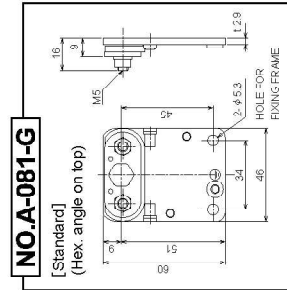

**NO.A-081-G**  
[Standard]  
(Hex. angle on top)

### Threaded shaft

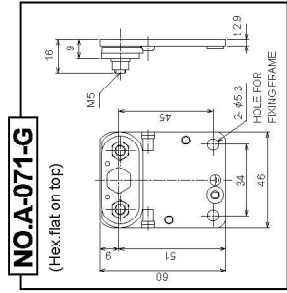
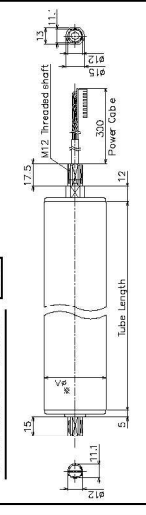

**NO.A-071-G**  
(Hex.flat on top)

### Installation

#### 1 Standard (Hex shaft)

Make screw holes to mount the mounting bracket on the conveyor frame where power cable goes through per illustrated below.

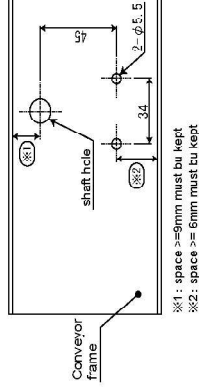

#### 3 Standard (Hex shaft)

Install the Mounting Bracket to the conveyor frame per illustrated below to stationary hold the Power Moller's shaft. Care must be paid not to damage the power cable or its connector.

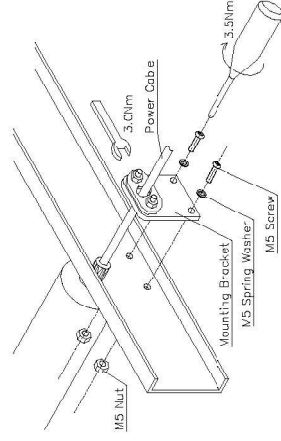

#### 3 Threaded shaft

Tighten M12 Nut into the threaded motor's shaft per illustrated below to stationary hold the Power Moller's shaft. Care must be paid not to damage the power cable or its connector.

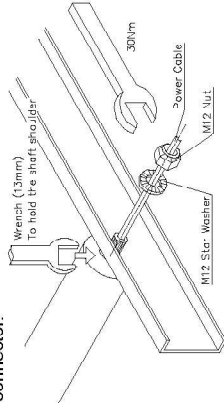

#### 2

Insert the unit's shaft with power cable through the conveyor frame shaft hole, taking attention not to injure the cable. Then, press the spring loaded shaft and insert it to the other side of conveyor frame shaft hole.

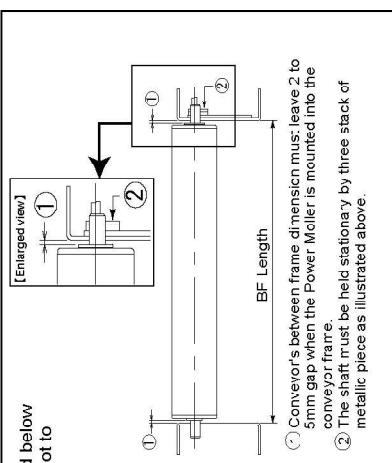
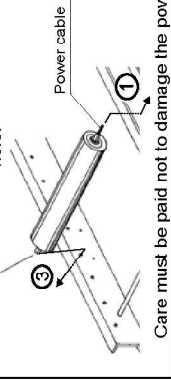

#### CAUTION

Make sure conveyor frame is grounded properly.

#### CAUTION

Unit's shaft must be fixed to the conveyor frame with Mounting bracket supplied with the unit. Rattling or idle rotation of the shaft may break the power cable, causing disconnection, by which the Power Moller will cease functioning.



#### ITOH DENKI CO., LTD.

Phone: +81 790 47 0955 Fax: +81 790 47 1325  
URL: <http://www.itohdenki.co.jp>  
Email: [info@itohdenki.co.jp](mailto:info@itohdenki.co.jp)

#### ITOH DENKI EUROPE S.A.

Phone: +33 450 03 09 99 Fax: +33 450 03 07 60  
URL: <http://www.itoh-denki.com>  
Email: [commercial@itoh-denki.com](mailto:commercial@itoh-denki.com)

#### ITOH DENKI USA, INC

Phone: +1 570 820 8811 Fax: +1 570 820 8838  
URL: <http://www.itohdenki.com>  
Email: [info@itohdenki.com](mailto:info@itohdenki.com)

#### ITOH DENKI ASIA LIMITED

Phone: +852 2427 2576/7 Fax: +852 2427 2203  
ITOH DENKI SHANGHAI COMPANY LIMITED  
Phone: +86 21 6341 0181 Fax: +86 21 6341 0180  
URL: <http://www.itohdenki.com.cn>

※ Specifications are subject to change without prior notice.