

POWER MOLLER® 24

SERIES

PM486/500FP [Brushless DC] HANDLING [Motorised Roller] INSTRUCTIONS

※ Motor driver is not inclusive and to be purchase separately.

We thank you for your purchase of our Power Moller.

Please read this handling instructions first to understand the product, safety information and cautions before using the product. Keep the handling instructions at certain place, to be ready whenever needed. Make sure whether the product you received complies to your purchase order, with its designation, specifications and operating voltage.

To use the product properly and safely

- Do not use the product in explosive, ignitable gas, corrosive, watery (except waterproof, dripproof unit) environment, or around flammable products.
- Switch off the power, when conveyor removal, wiring or maintenance is done, otherwise you have a risk of electrical shock or injury.
- Respect the electrical regulations of the site or the equipment, where the product is installed. (Labour safety and sanitary regulations, electrical equipment technical standard, etc)
- Make sure the conveyor is grounded.
- Also make sure the Power Moller's shafts are tightly fixed using the standard mounting brackets supplied together, before operating the unit.
- Do not pull, twist, injure, sandwich nor additionally process the power cable or connector.

Confirmation of the product

- ① Check whether you received the right product as you ordered, by the designation indicated on the label put on the endcap of the power cable side.

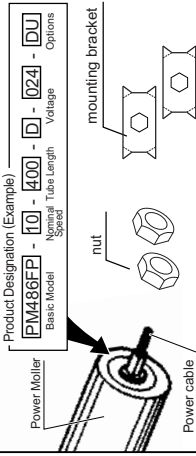

- ② Make sure if the mounting bracket and nut (each 2pcs for 1 Power Moller) are contained in the box.
※ Check with the drawings below

Power Source

- 24VDC Battery, or 24VDC Power Supply
- Battery or fullwave rectified and smoothed current < 10% Ripple

Dimensions

(Tube diameter ϕ A: PM486FP/ ϕ 48.6 PM500FP/ ϕ 50.0)

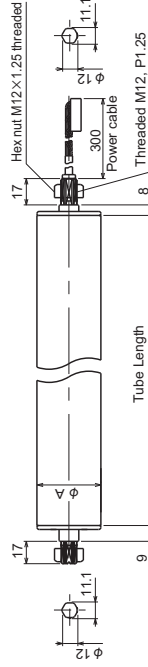

Mounting bracket

NO.P-0B1
(Hex. flat on top)

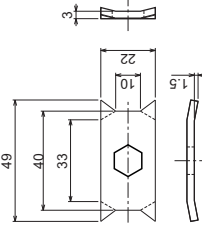

Installation

⚠ CAUTION

Unit's shaft must be fixed to the conveyor frame with Mounting bracket supplied with the unit. Rattling or idle rotation of the shaft may break the power cable, causing disconnection, by which the Power Moller will cease functioning.

1

Insert the Power Moller shaft from the power cable side through the conveyor frame shaft hole.

- Care must be paid not to injure, twist the cable or connector.

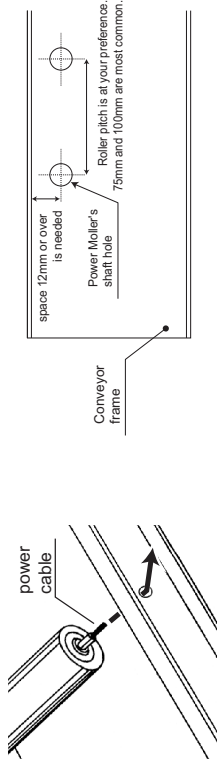

2

Press the spring-loaded shaft of the unit to put it through the other side of conveyor frame shaft.

⚠ CAUTION
Be careful not to injure your finger

【ADVICE】

Use of a screw driver facilitates the installation.

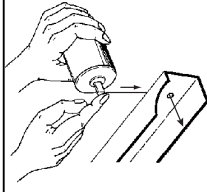

3

Put the mounting bracket to the conveyor frame to fix the Power Moller shaft.

- Care must be paid not to injure, twist the cable or connector.

※ Nut fastening should be first done on power cable side, then on the other side.
Screw fastening torque : 30Nm \pm 10%

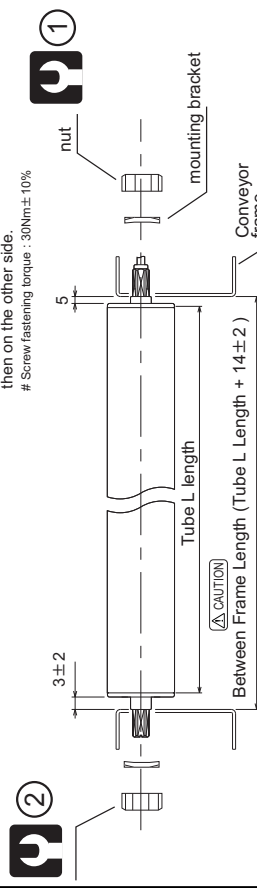

⚠ CAUTION

Make sure the unit is installed in the specified between frame length (tube L length + 14 \pm 2). Installation in the conveyor not satisfying the specified length would cause the malfunction.



ITO DENKI CO., LTD.

Phone: +81 790 47 0955 Fax: +81 790 47 1325
URL: <http://www.itohdenki.co.jp>
Email: info@itohdenki.co.jp

ITO DENKI USA, INC

Phone: +1 570 820 8811 Fax: +1 570 820 8638
URL: <http://www.itohdenki.com>
Email: info@itohdenki.com

ITO DENKI EUROPE S.A.

Phone: +33 450 03 09 99 Fax: +33 450 03 07 60
URL: <http://www.itoh-denki.com>
Email: commercial@itoh-denki.com

ITO DENKI ASIA LIMITED

Phone: +852 2427 2576/7 Fax: +852 2427 2203
URL: <http://www.itohdenki.com>
Email: info@itohdenki.com

ITO DENKI SHANGHAI COMPANY LIMITED
Phone: +86 21 6341 0181 Fax: +86 21 6341 0180

※ Specifications are subject to change without prior notice.